

## uvex ultravision goggle and shield fitting instructions

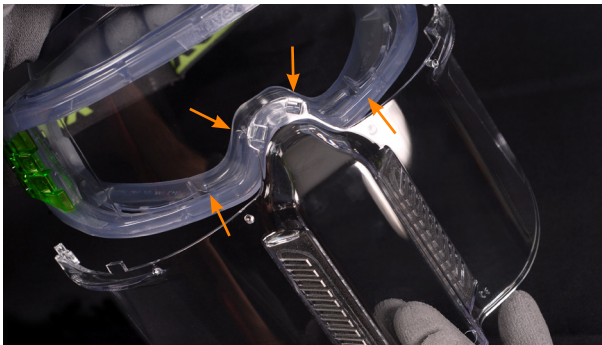

1



Align the goggle and shield so that the two small clips at the nose bridge clip over the rubber frame that runs along the bottom edge of the goggle.

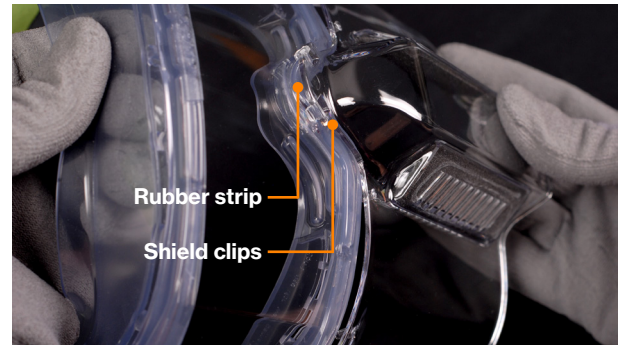

Ensure the two clips on the shield are secure behind the rubber strip on the goggle before moving on to the next step.

2

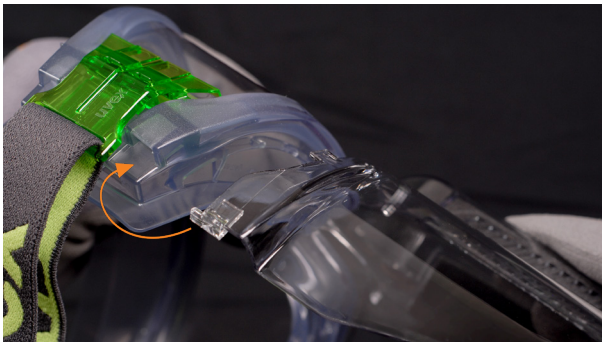

On either side of the face shield are two clear hooks. These need to be inserted into the space either side of the goggle, below the green clip.



You may need to flex the goggle or go in at a slight angle to insert the hook.

3

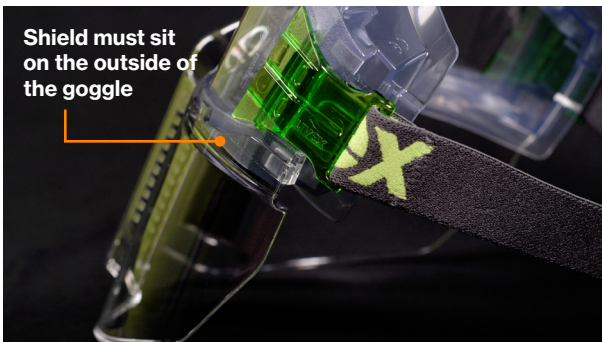

Once clipped together the face shield frame should sit on the outside of the goggle as pictured. Only the nose and side clips are inserted in to the frame.



Your combined uvex ultravision goggle and face shield is now ready to wear and can be detached using the same method in reverse.