



Hearing Protection

# Hearing Protection

All ears when it comes to safety

Noise-induced hearing loss is still one of the most common occupational hazards of all.

It develops painlessly, is progressive and generally goes unnoticed. It is the fact that it's irreversible which makes it so serious. The risk to hearing and the importance of hearing protection are often recognised too late.

Only those who suffer from hearing loss really understand just how essential a good sense of hearing is and that protecting it should be a top priority.

## What is noise?

Loud sounds which comprise noise not only pose a risk to hearing but can also be distracting and debilitating.

Persistent low-grade sounds such as a clock ticking or a dripping tap can also affect concentration levels.

## What are the consequences of noise?

We use our hearing continuously, it never gets a break and cannot be "switched off". We are exposed to noise every day, all day, from multiple sources so our hearing is under constant stress.

These daily demands on our ears can lead to irreversible noise-induced hearing loss. But, it's not just our hearing that is affected; noise means stress for the entire body. Noise affects us subconsciously and can lead to difficulty concentrating, gastrointestinal illness, elevated blood pressure and increased risk of a heart attack.

## Adverse health effects caused by harmful noise levels

Listed below are the maximum periods of time a person should be exposed to harmful noise per day without wearing hearing protection.

85 dB	8 hours	103 dB	7.5 minutes
88 dB	4 hours	106 dB	4 minutes
91 dB	2 hours	109 dB	2 minutes
94 dB	1 hour	112 dB	1 minute
97 dB	30 minutes	115 dB	30 seconds
100 dB	15 minutes		

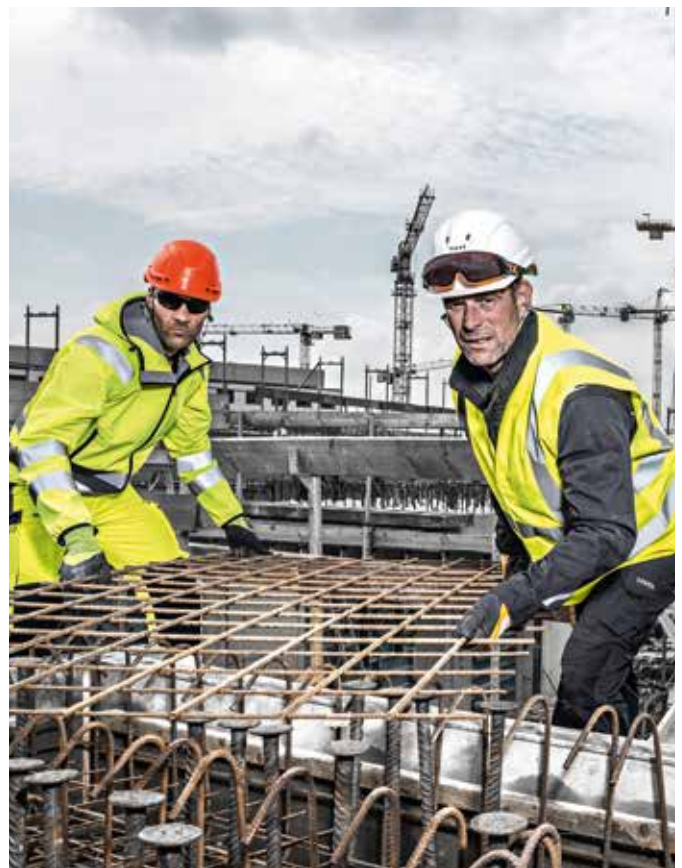



# Hearing Protection

All ears when it comes to safety

## Test and standards

All uvex hearing protection products comply with the AS/NZS standard and have been tested in accordance with AS/NZS 1270.

Continuous quality assurance with ISO 9001/2015.

Applicable standard norms are:

- AS/NZS 1270 - Acoustics - Hearing Protectors
- AS/NZS 1269.3 - Occupational Noise Management Hearing Protector Program

## Class of hearing protector required

LAeq,8h dB(A)	Class
Less than 90	1
90 to less than 95	2
95 to less than 100	3
100 to less than 105	4
105 to less than 110	5
Greater than 110 or equal to 110	Seek specialist advice

For the selection of hearing protectors according to the classification method  $L_{crit}A_{eq,8h}$  as 85 dB(A) e.g if a person is exposed to noise with a  $LA_{eq,8h}$  at 97dB(A) a Class 3 hearing protector is suitable



# Hearing protection

## Size and fit

Everyone's ear canal is unique – much like a fingerprint. Which is why it's all the more important that you choose adequate and suitable hearing protection that is the correct size to achieve a good fit. uvex offers a complete range of hearing protection to ensure all wearers are able to achieve a fit that's right for them.

**Choosing the wrong size can severely reduce the protection value, exposing wearers to harmful noise, and makes the ear plugs uncomfortable to wear.**

- if the earplugs are too large, they are unlikely to sit deep enough in the ear canal, so the specified protection level cannot be achieved. They'll also feel uncomfortable
- if the earplugs are too small, although they may be comfortable to wear, there could be noise leakage and reduced protection capacity which over time can cause noise-induced hearing loss.
- round earplugs don't necessarily completely seal an oval-shaped ear canal. It is on this premise that we developed the uvex xact-fit range of hearing protectors.

**It is best to try different sizes to find the one that gives you the best protection and fit. With the uvex com4-fit and uvex x-fit, we offer something for the majority of ear canal shapes.**

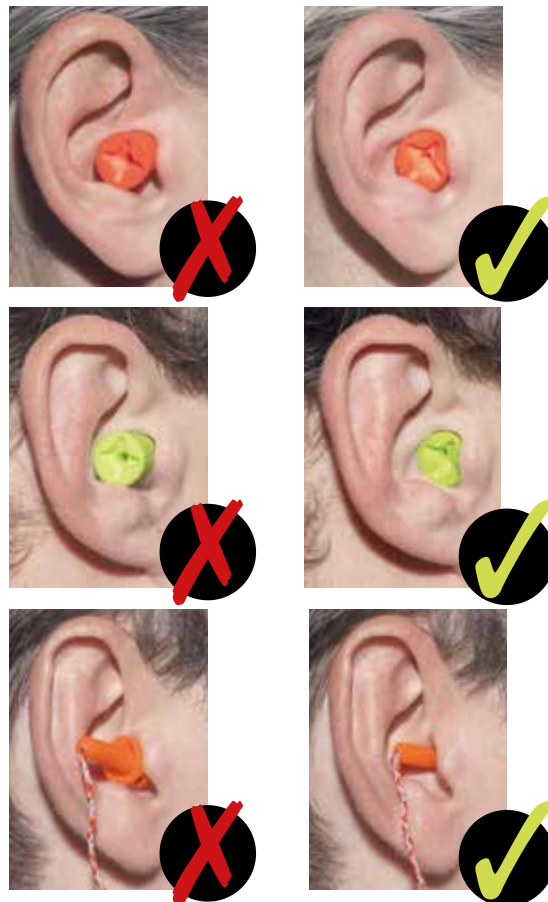

## Look out for the different sizes



The cross-section of an ear canal is oval shaped

Anyone can get used to wearing hearing protection; you just need to choose the right type of protection for you.

- wearing time
- noise levels
- choose earplugs according to the size of your ear canal
- earmuffs are not recommended for hot workplaces
- fitting accuracy (glasses wearers)

- for earmuff wearers, the weight should be taken into consideration
- handling (dirty hands, gloves, disabilities)
- compatibility with other PPE (helmet, glasses, respiratory protection)













**The right hearing protection can make even the loudest noises more comfortable.**

# Hearing Protection

Different situations, different ears

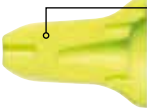

A unique design, even inside the earplugs

<b>uvex x-fit</b>				<ul style="list-style-type: none"> <li>• intricate recess design for long-term wearer comfort</li> <li>• designed to minimise pressure in the ear canal</li> </ul>
<b>uvex com4-fit</b>				<ul style="list-style-type: none"> <li>• grip section for easy insertion and removal</li> </ul>
<b>uvex hi-com</b>				<ul style="list-style-type: none"> <li>• Defined protection zone for controlled noise reduction, resulting in excellent speech and signal recognition and good communication</li> </ul>
<b>uvex xact-fit</b>				

## Hearing protection for every situation

There are many types of uvex hearing protection which are suitable for different situations and if you work in or are passing through high noise level areas you need the right level of protection.

It is important to strike the right balance between the need to adequately protect your hearing from dangerous

noise while not compromising your ability to hear and communicate. The below chart gives you an overview of which uvex earplug may be suitable based on the noise level.

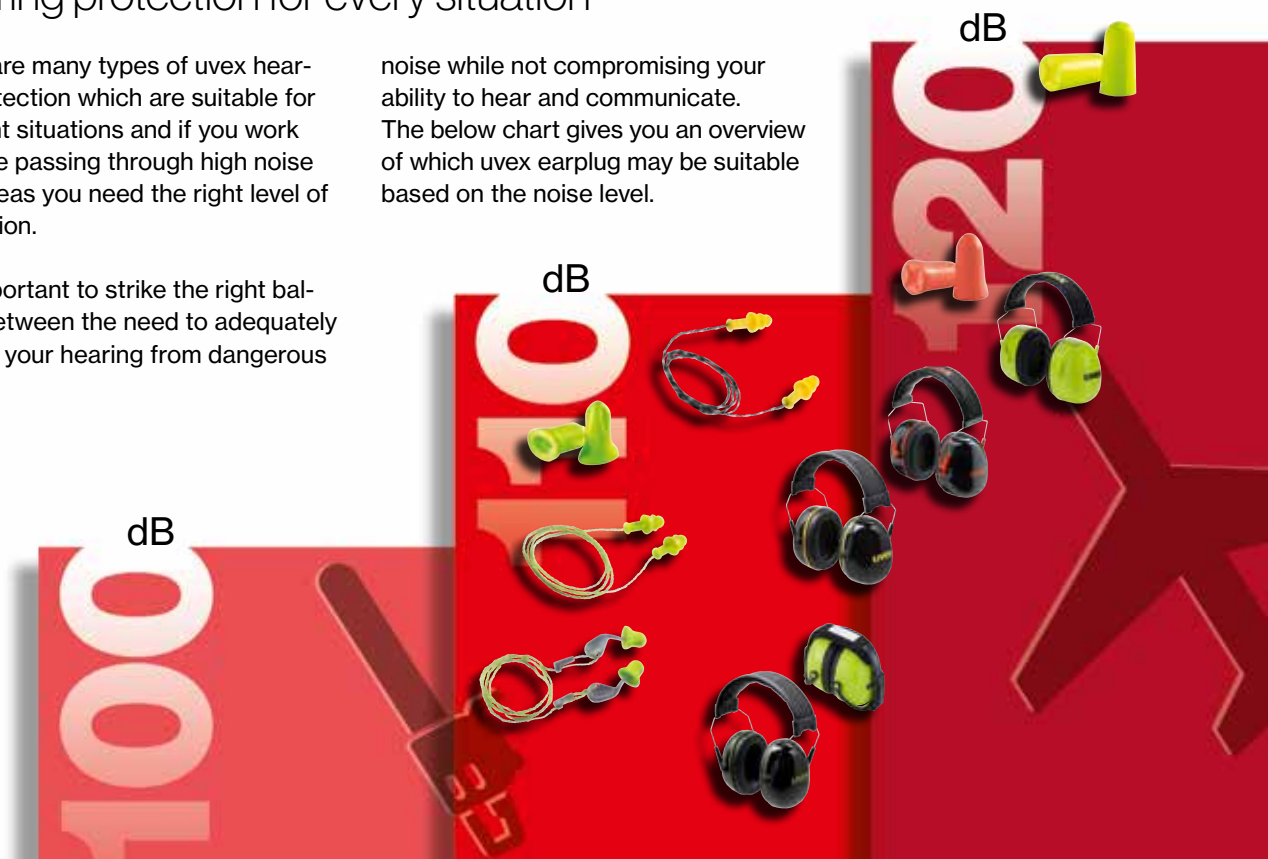



# Hearing protection

The uvex xact-fit family

## Using earplugs has never been easier

Easy, fast  
and accurate insertion

Medium protection capacity  
for excellent speech and  
signal recognition for easy  
communication

Replacement earplugs are  
available, for a cost-effective  
and environmentally  
conscious choice

No rolling required, so they  
can be used with dirty hands  
or while wearing gloves

Ergonomically shaped  
stems make fitting easy, hy-  
gienic, accurate and achieves  
a high level of wearer comfort

Thumb indentations with  
left and right marking ensures  
correct insertion and  
easy fitting

The shape means it  
fits most ear canals securely  
and comfortably



## The uvex xact-fit family



**uvex xact-fit**



**uvex xact-band**



**uvex xact-fit multi reusable S and M/L**

# Hearing protection

The uvex xact-fit family



## uvex xact-fit – intelligent ergonomics

A new dimension of wearer comfort



The cross-section of an ear canal is oval shaped

The stem is ergonomically shaped to fit either the left or right ear to increase wearer comfort and make the earplugs easier to insert and remove.

The design is easily identifiable from a distance, making it easier to monitor usage in accordance with your company's regulations.

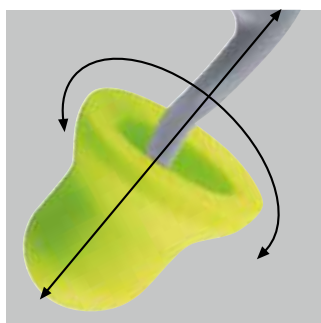

### Perfect fit

Oval-shaped foam earplugs mimic the natural shape of the ear canal for low pressure fit and enhanced comfort

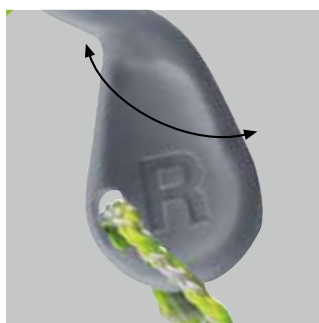

### Ergonomic thumb indentations

The ergonomic thumb indentations with left and right marking ensures correct insertion and easy fitting



### Adjustable cord

# Hearing protection

## Disposable ear plugs

### uvex hi-com

#### A unique design – even on the inside

Patented

Designed to minimise pressure in the ear canal

Reduced risk of over protection and feelings of isolation

Intricate recess design for long-term wearer comfort

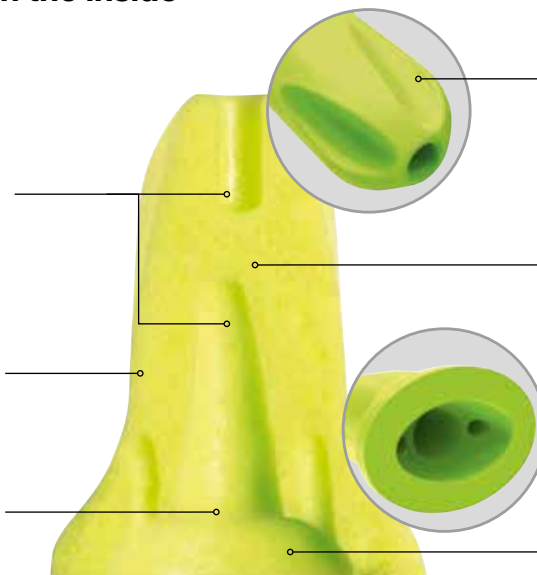

Large surface area delivers softer acoustics and absorbs inner ear sounds which can become obvious when wearing hearing protection in quieter areas

Defined protection zone for controlled noise reduction, resulting in excellent speech and signal recognition and good communication

Grip recess for easy removal



HC-UC



HC-UC-F



### uvex hi-com

- delivers low, flat attenuation allowing for excellent speech and sound recognition
- available in two colours
- large surface area delivers softer acoustics and absorbs inner ear sounds which can become obvious when wearing hearing protection in quieter areas

#### uvex hi-com

Part No.	HC-UC	HC-PB	HC-UC-F
Design	without cord	without cord	without cord
Standard	AS/NZS 1270	AS/NZS 1270	AS/NZS 1270
SLC80	16 dB, Class 2	16 dB, Class 2	16 dB, Class 2
Colour	lime	lime	fawn
Packaging	200 pairs, packed in pairs	200 pairs, refill polybag	200 pairs, packed in pairs

#### SLC80: 16 dB, Class 2

Frequency in Hertz	125	250	500	1000	2000	4000	8000
Mean	14.4	14.8	16.8	19.3	27.0	28.9	28.6
STD. Deviation	7.5	7.7	7.4	5.9	7.3	7.2	8.7
Mean minus SD	6.9	7.1	9.5	13.4	19.7	21.7	19.9



# Hearing Protection

## Disposable ear plugs



CF-CD



CF-UC



### uvex com4-fit

- disposable earplugs with a compact, ergonomic design
- perfect for narrow and smaller ear canals
- suitable for use in high noise environments
- patented x-grip technology reduces pressure on the ear canal and aids easy, hygienic removal
- increased wearing comfort, when worn for extended periods

uvex com4-fit			
<b>Part No.</b>	CF-UC	CF-CD	CF-PB
<b>Design</b>	without cord	with cord	without cord
<b>Standard</b>	AS/NZS 1270	AS/NZS 1270	AS/NZS 1270
<b>SLC80</b>	22 dB, Class 4	22 dB, Class 4	22 dB, Class 4
<b>Colour</b>	orange	orange	orange
<b>Packaging</b>	200 pairs, packed in pairs	100 pairs, packed in pairs	200 pairs, dispenser refill

uvex com4-fit			
<b>Part No.</b>	CF-UC-B	CF-UC-D	
<b>Design</b>	without cord	without cord	
<b>Standard</b>	AS/NZS 1270	AS/NZS 1270	
<b>SLC80</b>	22 dB, Class 4	22 dB, Class 4	
<b>Colour</b>	orange	orange	
<b>Packaging</b>	7000 pairs, bulk pack	500 pairs, for wall dispenser	

SLC80 22 dB, Class 4								
Frequency in Hertz	125	250	500	1000	2000	4000	8000	
Mean	20.7	20.1	23.5	24.6	29.6	36.2	36.2	
STD. Deviation	7.8	7.8	7.9	5.1	5.3	5.5	6.5	
Mean minus SD	12.9	12.2	15.6	19.5	24.3	30.6	29.6	



XF-CD



XF-UC



### uvex x-fit

- tapered plug shape ensures natural, pressure free fit – maximising comfort and protection levels
- suitable for use in high noise environments
- patented x-grip technology reduces pressure on the ear canal and aids easy, hygienic removal

uvex x-fit			
<b>Part No.</b>	XF-UC	XF-CD	XF-PB
<b>Design</b>	without cord	with cord	without cord
<b>Standard</b>	AS/NZS 1270	AS/NZS 1270	AS/NZS 1270
<b>SLC80</b>	26 dB, Class 5	26 dB, Class 5	26 dB, Class 5
<b>Colour</b>	lime	lime	lime
<b>Packaging</b>	200 pairs, packed in pairs	100 pairs, packed in pairs	200 pairs, dispenser refill

uvex x-fit			
<b>Part No.</b>	XF-UC-B	XF-UC-D	2112.133
<b>Design</b>	without cord	without cord	without cord
<b>Standard</b>	AS/NZS 1270	AS/NZS 1270	AS/NZS 1270
<b>SLC80</b>	26 dB, Class 5	26 dB, Class 5	26 dB, Class 5
<b>Colour</b>	lime	lime	lime
<b>Packaging</b>	7000 pairs, bulk pack	500 pairs, for wall dispenser	15 pairs, retail pack

SLC80 26 dB, Class 5								
Frequency in Hertz	125	250	500	1000	2000	4000	8000	
Mean	26.0	28.2	28.7	29.0	34.6	39.5	42.3	
STD. Deviation	8.2	9.6	8.8	6.7	4.6	6.0	8.6	
Mean minus SD	17.7	18.6	20.0	22.3	30.1	33.5	33.7	

# Hearing Protection

Disposable ear plugs



## uvex xact-fit

- disposable earplugs uniquely shaped to match the anatomy of the ear canal
- tapered plug shape ensures natural, pressure free fit – maximising comfort and protection levels
- left / right pod carriers simplify fitting and ensure accurate fit every-time
- replacement earplugs can be dispensed through the standard uvex wall mounted dispenser unit
- sealed PU foam reduces the potential for contamination
- adjustable neck cord can be altered to wearers requirements for increased safety

uvex xact-fit	uvex xact-fit replacement pods
<b>Part.no.</b> XA-CD	XA-RP
<b>Design</b> with reusable pin	replacement pods
<b>Standard</b> AS/NZS 1270	AS/NZS 1270
<b>SLC80</b> 22 dB, Class 4	22dB, Class 4
<b>Colour</b> lime	lime
<b>Packaging</b> 50 pairs, paired in mini box	250 pairs, 5 pairs, packed in mini box

SLC80 22 dB, Class 4							
Frequency in Hertz	125	250	500	1000	2000	4000	8000
Mean	15.8	19.0	22.6	24.8	31.8	35.3	39.3
STD. Deviation	5.0	6.5	7.6	6.5	3.2	5.1	5.4
Mean minus SD	10.8	12.5	15.0	18.3	28.6	30.2	33.9



AC-PD



## uvex earplug dispenser “one2click”

- easy-to-use and robust wall-mounted dispenser
- earplugs available to hand with just one click
- collecting tray prevents earplugs from falling on the floor
- suitable for all uvex disposable uncorded earplugs
- quantity: 600pairs
- the transparent design makes refilling easy to monitor

uvex earplug dispenser	
<b>Part No.</b>	AC-PD
<b>Colour</b>	transparent, grey, sky blue
<b>Packaging</b>	1 unit
Earplugs not included.	

# Hearing Protection

## Reusable ear plugs



WP-CD

### uvex whisper +

- easy-to-clean reusable corded earplugs
- smooth, dirt-repellent surface can be easily cleaned using soap and water
- with the cord, the earplugs are conveniently on hand and can be worn comfortably around the neck

uvex whisper +	
<b>Part No.</b>	WP-CD
<b>Design</b>	with cord
<b>Standard</b>	AS/NZS 1270
<b>SLC80</b>	22 dB, Class 4
<b>Colour</b>	lime
<b>Packaging</b>	50 pairs, paired in mini box

SLC80 22 dB, Class 4							
Frequency in Hertz	125	250	500	1000	2000	4000	8000
Mean	25.8	24.7	25.2	24.7	29.3	33.7	39.4
STD. Deviation	6.4	6.4	6.8	5.5	5.7	7.5	7.2
Mean minus SD	19.4	18.3	18.4	19.2	23.6	26.2	32.2



2124019

### uvex xact-fit multi reusable

COMING SOON

- Reusable earplugs with thumb indentations
- oval-shaped earplugs mimics the natural shape of the ear canal for optimum fit and comfort
- interchangeable replacement earplugs
- can be handled with dirty hands or while wearing gloves
- available in two sizes

uvex xact-fit multi reusable S	
<b>Part No.</b>	2124019
<b>Design</b>	with oval-shaped reusable earplugs, in minibox
<b>Standard</b>	AS/NZS 1270
<b>SLC80</b>	19 dB, Class 3
<b>Colour</b>	grey, transparent
<b>Size</b>	S
<b>Packaging</b>	50 PR, paired in mini box



2124020

uvex xact-fit multi reusable M/L	
<b>Part No.</b>	2124020
<b>Design</b>	with oval-shaped reusable earplugs, in minibox
<b>Standard</b>	AS/NZS 1270
<b>SLC80</b>	19 dB, Class 3
<b>Colour</b>	grey, transparent
<b>Size</b>	M/L
<b>Packaging</b>	50 PR, paired in mini box

SLC80 19dB, Class 3							
Frequency in Hertz	125	250	500	1000	2000	4000	8000
Mean	24.8	20.8	24.9	25.2	29.1	29.9	35.3
STD. Deviation	9.9	9.1	10.6	9.7	7.1	9.4	9.7
Mean minus SD	14.9	11.7	14.3	15.5	22.0	20.5	25.6



# Hearing Protection

Detectable ear plugs



XF-DT

## uvex x-fit detec

- disposable earplugs coloured blue (for the food industry) with metal component for easy detection
- suitable for use in high noise environments
- tapered shape matches the ear canal anatomy for comfortable and secure fit
- patented x-grip technology reduces pressure on the ear canal and aids easy, hygienic removal
- sealed PU foam reduces the potential for contamination

uvex x-fit detec

<b>Part No.</b>	XF-DT
<b>Design</b>	with cord
<b>Standard</b>	AS/NZS 1270
<b>SLC80</b>	26 dB, Class 5
<b>Colour</b>	blue
<b>Packaging</b>	100 pairs

SLC80 26 dB, Class 5

Frequency in Hertz	125	250	500	1000	2000	4000	8000
Mean	26.0	28.2	28.7	29.0	34.6	39.5	42.3
STD. Deviation	8.2	9.6	8.8	6.7	4.6	6.0	8.6
Mean minus SD	17.7	18.6	20.0	22.3	30.1	33.5	33.7



WP-DT

## uvex whisper+ detec

- reusable, detectable pre-shaped plug
- coloured blue with metal component (for the food industry) for easy detection in production areas
- tapered smooth fins fit the natural shape of the ear canal, are comfortable on the skin, reduce pressure for long-term wear and provides a good comfortable seal against external noise
- flat attenuation for excellent speech recognition
- can be washed with soap and water and stored for repeated use

uvex whisper+ detec

<b>Part No.</b>	WP-DT
<b>Design</b>	with cord
<b>Standard</b>	AS/NZS 1270
<b>SLC80</b>	22 dB, Class 4
<b>Colour</b>	blue
<b>Packaging</b>	50 pairs, paired in mini box

SLC80 22 dB, Class 4

Frequency in Hertz	125	250	500	1000	2000	4000	8000
Mean	25.8	24.7	25.2	24.7	29.3	33.7	39.4
STD. Deviation	6.4	6.4	6.8	5.5	5.7	7.5	7.2
Mean minus SD	19.4	18.3	18.4	19.2	23.6	26.2	32.2

MADE IN SWEDEN

# Hearing Protection

## Detectable ear plugs · Banded hearing protection



XA-BD

### uvex xact-band

- banded ear protector
- replacement pods available
- replacement earplugs can be dispensed through the standard uvex wall mounted dispenser unit
- ergonomically shaped plugs create a perfect fit
- thumb indentations on the stems for quick and easy fitting
- integrated sound absorbers reduce noise transmission through the band
- extremely low weight – just 4 grams

uvex xact-band		
<b>Part No.</b>	2125.372	XA-RP
<b>Design</b>	earband	replacement pods
<b>Standard</b>	AS/NZS 1270	AS/NZS 1270
<b>SLC80</b>	22 dB, Class 4	22dB, Class 4
<b>Colour</b>	grey/sky blue	lime
<b>Packaging</b>	5	250 pairs, 5 pairs in mini box

SLC80 22 dB, Class 4								
Frequency in Hertz	125	250	500	1000	2000	4000	8000	
Mean	25.7	21.4	23.7	25.5	32.5	39.1	37.3	
STD. Deviation	5.8	5.5	6.8	7.0	7.3	9.8	8.7	
Mean minus SD	19.8	15.9	16.9	18.5	25.2	29.3	28.6	



AC-BT

### uvex earplug hygiene box

- box for hygienic earplug storage
- compact and dirt-resistant design

uvex earplug hygiene box	
<b>Part No.</b>	AC-BT
<b>Colour</b>	transparent
<b>Packaging</b>	50 pieces / box
Earplugs not included.	

# Hearing Protection

Making the right choice is essential

## What level of protection is required?

Noise levels in the workplace must be measured first in order to determine what level of protection is required. The Health and Safety professional or external qualified service providers should conduct tests using approved test equipment.

The continuous noise level and, if necessary, the peak emission noise level are measured, enabling a noise profile to be recorded.

Appropriate hearing protection can then be selected using the SLC80 method.

## Objective: noise level – SLC80 value

The objective when choosing suitable hearing protection is to achieve an effective residual noise level of between 70 dB and 80 dB for the wearer.

If the protection level is too high (over-protection), this can result in the inability to communicate and the risk of not hearing critical messages, instructions or signals.

Example:

$$\text{Noise level } 100 \text{ dB} - \text{uvex x-fit, SLC80 } 26 \text{ dB} = \mathbf{74 \text{ dB}}$$

## RANGE

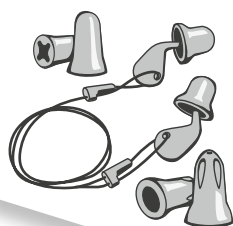

### uvex disposable hearing protection plugs

Outstanding safety for single use: uvex disposable hearing protection plugs offer excellent wearer comfort when worn for long periods.



### uvex reusable ear plugs

Readily available and easy to clean: uvex reusable ear plugs with hygiene box are reliable companions for your every-day work.

## USE

To guarantee optimum hearing protection, ear plugs must be fitted correctly.



1 Briefly roll down uvex disposable hearing protection plugs.



2 Put your arm over your head and move the ear slightly upwards to straighten your auditory canal. This achieves a better fit.

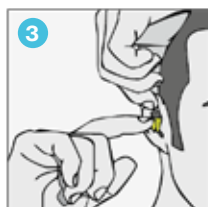

3 Insert plugs and hold in place while they expand. If they are not visible from the front, then they are in the right position.

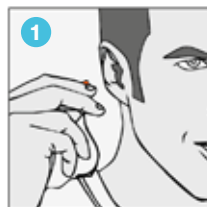

1 Take uvex reusable ear plugs by the handles and place the cord around your neck.

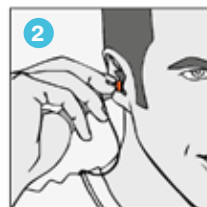

2 Insert ear plugs into the auditory canal, applying gentle pressure.

## HYGIENE

In dirty working environments, particles can easily stick to the surface of materials and cause minor injuries in the ears.



Please dispose of disposable ear plugs after each use.

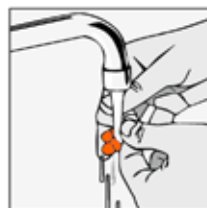

Alternatively, clean them with water and mild soap.



Dry them and store in the uvex hygiene box when not in use.



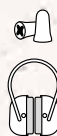

Earmuffs

# uvex aXess one

safe. active. connected.



## RAL – real active listening

Active listening function with the ability to individually adjust the volume of ambient noise. Safe application thanks to integrated sound level limiter.

## Bluetooth® 5.0

Good sound quality, fast data transfer and a large range with optimised energy consumption.

## Dual connection mode

The hearing protection can be paired with two Bluetooth devices at the same time.

## Certified hearing protection

Attenuation value with SLC80 27dB

## Suitable for outdoor use

Suitable for dusty and damp working areas thanks to sealing caps.

## Hands-free telephony

Make calls without interrupting your work thanks to Bluetooth connectivity.

## Audio streaming

Ideal for monotonous work.

## Two surround-sound microphones

For reliable transmission of ambient noise.

## Voice microphone

Ensures optimal voice quality.

## Status messages

The audio assistant provides you information through voice prompts ("Bluetooth connected"), so there's no need to remove the hearing protection in hazardous areas.

## External audio input

Connects wireless devices or media players via a cable.

## Charging socket USB Type-C

Fast charging time thanks to higher performance. Easy handling thanks to rotationally symmetrical connectors.

## LED display

Signals your current work mode, e.g. whether you are making a phone call or are available.

## Unique function keys

Can be felt easily and can also be operated even when wearing gloves.



# Hear what's important

## The smart hearing protection for greater occupational safety

### Outdoor microphones for secure communication

uvex aXess one are active electronic earmuffs with RAL function (real active listening). This function gives the user the feeling of not wearing hearing protection and of actively participating in the environment with hearing protection. This makes communication possible and warning signals can be perceived better. The volume of the ambient sounds can be set individually.

For safe hearing protection, the maximum output level is limited. The level gain below the sound level limiter is very helpful, for example when adjusting machines or performing diagnostic work.

### Conveniently answer calls via Bluetooth®

uvex aXess one connects to your smartphone via Bluetooth 5.0, meaning you no longer miss important calls and can make them without interrupting your work. Dual mode allows you to add another device if needed.

Calls can be answered quickly and easily using the function keys on the earmuffs, so both hands are free when you make calls. The large radio range ensures that paired devices can remain in a protected location rather than at the workplace.



2640.001



### Protection against dust and moisture

Closure caps seal connector sockets.



### uvex aXess one

- active Bluetooth® earmuffs with foldable headband
- communication, telephony and streaming
- attenuation of harmful impulse noise
- real active listening (RAL) function for clear perception of ambient noise
- buttons with a shape that corresponds to their function
- water protected, ideal for outdoor applications
- battery status indicator and battery warning message
- continuous length adjustment for the perfect positioning
- padded headband for a comfortable fit

uvex aXess one	
<b>Part No.</b>	2640.001
<b>Design</b>	Active earmuffs with Bluetooth
<b>Standard</b>	AS/NZS 1270
<b>SLC80</b>	27dB, Class 5
<b>Weight</b>	360 g
<b>Colour</b>	matt black, grey
<b>Packaging</b>	1 unit

SLC80 27 dB Class 5							
Frequency in Hertz	125	250	500	1000	2000	4000	8000
Mean	14.8	16.3	23.5	33.1	34.3	41.4	40.1
STD. Deviation	3.5	3.3	3.7	3.5	3.4	5.6	4.2
APV	11.3	13.0	19.8	29.6	30.9	35.8	35.9



# Hearing Protection

## Earmuffs



**SLC80 dB**  
**27** 2630010



**SLC80 dB**  
**30** 2630020



**SLC80 dB**  
**32** 2630030

**Note:** Order earmuff bag separately



### uvex K10 · uvex K20 · uvex K30

- earmuffs with foldable headband
- variable length adjustment for easy positioning
- optimal earmuff shape for pressure-free protection of the outer ear
- padded headband for wearer comfort

**COMING SOON**

- wearer comfort guaranteed thanks to extra-soft memory foam earmuff cushions, even when worn for long periods
- replaceable earmuff cushions for high hygiene requirements

	uvex K10	uvex K20	uvex K30
<b>Part No.</b>	2630010	2630020	2630030
<b>Design</b>	with foldable headband	with foldable headband	with foldable headband
<b>Standards</b>	AS/NZS 1270	AS/NZS 1270	AS/NZS 1270
<b>SLC80</b>	27 dB, Class 5	30 dB, Class 5	32 dB, Class 5
<b>Weight</b>	185 g	230 g	385 g
<b>Colour</b>	black, green	black, yellow	black, red
<b>Packaging</b>	1 unit	1 unit	1 unit

SLC80 27 dB Class 5 - uvex K10								
Frequency in Hertz	125	250	500	1000	2000	4000	8000	
Mean	14.5	15.8	26.1	35.3	35.8	33.0	35.1	
STD. Deviation	4.2	3.7	3.9	3.7	3.2	4.7	5.6	
APV	10.3	12.1	22.2	31.6	32.6	28.3	29.5	

SLC80 30 dB Class 5 - uvex K20								
Frequency in Hertz	125	250	500	1000	2000	4000	8000	
Mean	16.2	20.4	30.6	40.1	36.5	35.8	36.7	
STD. Deviation	4.5	4.4	5.3	4.5	3.9	4.4	4.0	
APV	11.7	16.0	25.3	35.6	32.6	31.4	32.7	

SLC80 32 dB Class 5 - uvex K30								
Frequency in Hertz	125	250	500	1000	2000	4000	8000	
Mean	20.5	23.4	32.3	40.1	37.1	39.9	40.2	
STD. Deviation	4.9	5.1	4.7	5.3	4.4	4.2	5.0	
APV	15.6	18.3	27.6	34.8	32.7	35.7	35.2	

# Hearing Protection

## Earmuffs



SLC80  
dB  
27



2630.011

COMING SOON

### uvex KX10

- earmuffs with rubberised surface
- increased grip and secure fit, ideal for oily or damp environments
- foldable headband
- variable length adjustment for easy positioning
- optimal earmuff shape for pressure-free protection of the outer ear
- padded headband for wearer comfort
- comfortable fit guaranteed thanks to extra-soft memory foam earmuff cushions, even when worn for long periods
- replaceable earmuff cushions for high hygiene requirements

uvex KX10	
<b>Part No.</b>	2630011
<b>Design</b>	Hearing protection earmuffs with rubberised surface
<b>Standards</b>	AS/NZS 1270
<b>SLC80</b>	27 dB, Class 5
<b>Weight</b>	185 g
<b>Colour</b>	mat black, grey
<b>Packaging</b>	1 unit

SLC80 27 dB Class 5 - uvex K10								
Frequency in Hertz	125	250	500	1000	2000	4000	8000	
Mean	14.5	15.8	26.1	35.3	35.8	33.0	35.1	
STD. Deviation	4.2	3.7	3.9	3.7	3.2	4.7	5.6	
APV	10.3	12.1	22.2	31.6	32.6	28.3	29.5	

SLC80  
dB  
30



2630.021

COMING SOON

### uvex K20 hi-viz

- earmuffs in fluorescent colours thanks to the high-visibility design
- foldable headband
- variable length adjustment for easy positioning
- optimal earmuff shape for pressure-free protection of the outer ear
- padded headband for wearer comfort
- comfortable fit guaranteed thanks to extra-soft memory foam earmuff cushions, even when worn for long periods
- replaceable earmuff cushions for high hygiene requirements

uvex K20 hi-viz	
<b>Part No.</b>	2630021
<b>Design</b>	with foldable headband
<b>Standards</b>	AS/NZS 1270
<b>SLC80</b>	30 dB, Class 5
<b>Weight</b>	230 g
<b>Colour</b>	hi-viz
<b>Packaging</b>	1 unit

SLC80 30 dB Class 5								
Frequency in Hertz	125	250	500	1000	2000	4000	8000	
Mean	16.2	20.4	30.6	40.1	36.5	35.8	36.7	
STD. Deviation	4.5	4.4	5.3	4.5	3.9	4.4	4.0	
APV	11.7	16.0	25.3	35.6	32.6	31.4	32.7	

# Hearing Protection

## Earmuffs



### uvex K1 · uvex K2 · uvex K3 · uvex K4

- earmuffs with length adjustment
- lightweight with a small cup
- easily adjustable for a perfect fit

- padded headband for optimum wearer comfort
- wearer comfort guaranteed thanks to extra-soft memory foam ear cushions, even when worn for long periods (excluding uvex K1)

	uvex K1	uvex K2	uvex K3	uvex K4
<b>Art. no.</b>	2610.001	2610.002	2610.003	2610.004
<b>Design</b>	with headband	with headband	with headband	with headband
<b>Standard</b>	AS/NZS 1270	AS/NZS 1270	AS/NZS 1270	AS/NZS 1270
<b>SLC80</b>	28 dB Class 5	31 dB, Class 5	33 dB, Class 5	35 dB, Class 5
<b>Weight</b>	180 g	217 g	297 g	356 g
<b>Colour</b>	black, green	black, yellow	black, red	neon lime
<b>Packaging</b>	1 unit	1 unit	1 unit	1 unit

SLC80 28 dB Class 5 - uvex K1							
Frequency in Hertz	125	250	500	1000	2000	4000	8000
Mean	15.8	16.0	26.5	33.9	37.2	39.6	39.7
STD. Deviation	4.1	3.2	3.6	3.1	3.0	3.7	3.8
Mean minus SD	11.7	12.8	22.9	30.8	34.2	35.9	35.9

SLC80 31 dB Class 5 - uvex K3							
Frequency in Hertz	125	250	500	1000	2000	4000	8000
Mean	17.6	18.5	29.6	36.8	37.2	42.7	41.0
STD. Deviation	4.7	2.9	3.6	3.1	2.9	2.9	3.9
Mean minus SD	12.9	15.6	26.0	33.7	34.3	39.8	37.1

SLC80 33 dB Class 5 - uvex K2							
Frequency in Hertz	125	250	500	1000	2000	4000	8000
Mean	19.6	21.7	33.6	38.4	37.7	37.3	41.1
STD. Deviation	2.6	2.9	2.5	2.9	2.9	2.7	2.6
Mean minus SD	17.0	18.8	31.1	35.5	34.8	34.6	38.5

SLC80 35 dB Class 5 - uvex K4							
Frequency in Hertz	125	250	500	1000	2000	4000	8000
Mean	21.7	24.4	35.6	41.0	38.0	43.8	45.7
STD. Deviation	2.2	2.8	3.0	3.7	3.3	3.2	2.9
Mean minus SD	19.5	21.6	32.6	37.3	34.7	40.6	42.8



# Hearing Protection

## Earmuffs | Helmet earmuffs for 30-mm Euroslot



SNR  
dB  
28



2610.200



possible wearing  
styles

### uvex K200

- dielectric ear muffs with length adjustment
- suitable for use in workplace environments with exposure to electrical voltage
- adjustable headband for a perfect fit and optimum protection
- easily adjustable for a customised fit
- range of positions possible with 360° capsule rotation

uvex K200	
Part No.	2610.200
Design	with 360° headband rotatable
Standard	AS/NZS c1270
SLC80	28 dB, Class 5
Weight	173 g
Colour	black, ochre
Order unit	1 unit

SLC80 28 dB Class 5								
Frequency in Hertz	125	250	500	1000	2000	4000	8000	
Mean	15.1	16.6	25.7	32.7	35.2	38.8	39.8	
STD. Deviation	4.6	3.2	3.7	2.8	2.9	3.3	3.7	
Mean minus SD	10.5	13.4	22.0	29.9	32.3	35.5	36.1	

COMING SOON

SLC80  
dB  
23



2630.220

### uvex K30H

- hearing protection earmuffs that can be attached to a safety helmet using the 30-mm Euroslot
- dielectric design
- soft, variable length adjustment
- sound isolation thanks to the rubber-cushioned earmuffs
- length is easily adjustable for a perfect fit on the helmet
- 360° rotation for standby and resting positions
- wearer comfort guaranteed thanks to extra-soft memory foam earmuff cushions, even when worn for long periods

uvex K30H	
Part No.	2630.230
Design	dielectric helmet earmuffs for 30-mm Euroslot
Standard	AS/NZS 1270
SLC80	23 dB, Class 4
Weight	420 g
Colour	black, red
Packaging	1 pair

SLC80 23 dB Class 4								
Frequency in Hertz	125	250	500	1000	2000	4000	8000	
Mean	11.0	13.6	23.3	33.3	32.5	32.9	30.5	
STD. Deviation	7.3	5.7	6.0	5.9	4.5	5.9	8.9	
Mean minus SD	3.7	7.9	17.3	27.4	28.0	27.0	21.6	

# Hearing Protection

Earmuff accessories



AC-EB

**uvex earmuff bag**

- with belt loop and Velcro fastener
- put away hearing protectors quickly and easily, while keeping them close to hand
- fits all uvex hearing protectors

uvex earmuff bag	
Part No.	AC-EB
Design	with belt loop and hook and loop fastener
Colour	black
Packaging	1 unit



2599.971  
2599.972

**uvex K Series - Hygiene kits**

	uvex K series hygienekit standard	uvex K series hygienekit-premium
Part No.	2599.971	2599.972
Design	accessories for uvex K1, uvex K200	accessories for uvex K2, uvex K3, uvex K4 uvex K10, uvex KX10, uvex K20 uvex K30, uvex, uvex K30H, uvex aXess one
Content	2 ear pads and 2 muffling pads in BG	2 ear pads and 2 muffling pads in BG
Packaging	1 set	1 set